

# INTRODUCING THE FIRST EVER UNIVERSAL SIGN BRACKETS

Designed to be used with a wide variety of signage types including, but not limited to, **high density urethane, wood, illuminated & non-illuminated** types of signage.



## 3 Bracket Options!

ITEM #	VERTICAL DIMENSION	HORIZONTAL DIMENSION
UNIV-XSM	7.5"	6-3/16"
UNIV-SM	13.5"	11.5"
UNIV-MED	24"	22"
UNIV-LG	24"	44"

**NEW!**

Universal Sign Brackets are welded & prepunched using the highest grade of 3/16" steel available. Each bracket is powder coated white for ultimate protection and has four 2 1/4" holes in each corner & 1/4" counter sink for multifastening options.

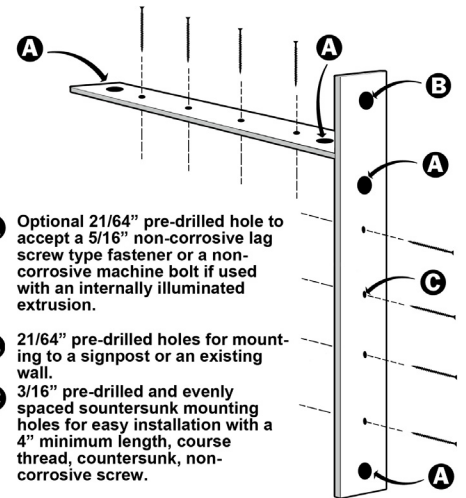

- A** Optional 21/64" pre-drilled hole to accept a 5/16" non-corrosive lag screw type fastener or a non-corrosive machine bolt if used with an internally illuminated extrusion.
- B** 21/64" pre-drilled holes for mounting to a signpost or an existing wall.
- C** 3/16" pre-drilled and evenly spaced countersunk mounting holes for easy installation with a 4" minimum length, coarse thread, countersunk, non-corrosive screw.

## SIGN MOUNTING EXAMPLES

BETWEEN POLE MOUNT

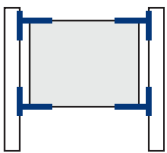

BOTTOM/TOP MOUNT EXISTING

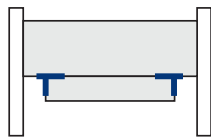

MULTI BETWEEN POLE

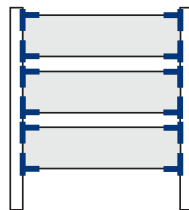

WALL MOUNT PROJECTION

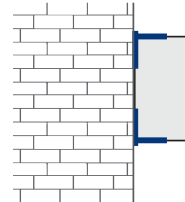

BETWEEN POLE MIX & MATCH

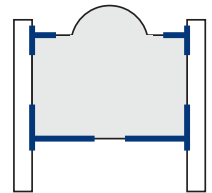

UNDER CANOPY MOUNT

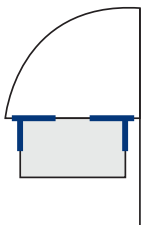

DOUBLE PROJECTION

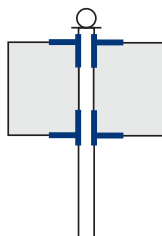

SIDE MOUNT EXISTING

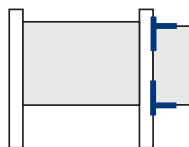

SINGLE BRACKET PROJECTION

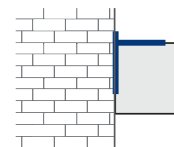

SINGLE POLE PROJECTION

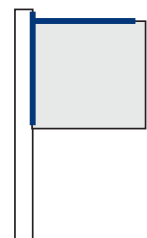

**Sign, Graphics, Awning & Marine Canvas Supplies**  
125 Amara Street, East Providence, RI 02915  
www.nepcosignsupply.com

**800-327-7562**  
401-438-4550 ~ FAX 401-438-1533

Daily Deliveries Throughout  
New England and Nearby New York

SKU#: UNIV-XSM

X-Small Universal Bracket

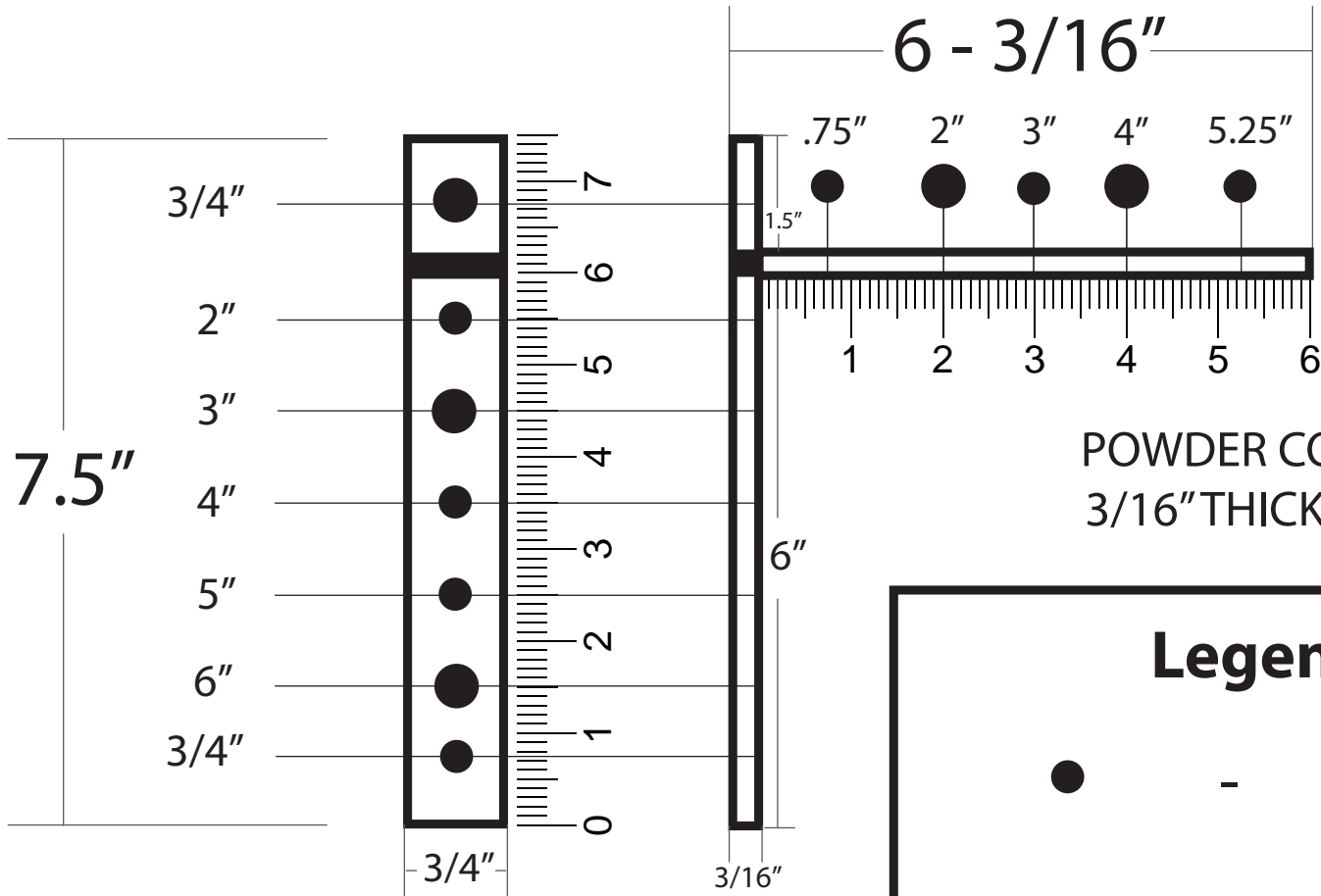

POWDER COATED WHITE  
3/16" THICK X 3/4" STEEL

**NOTE!**  
Steel is NOT the same as #UNIV-SM #UNIV-MED #UNIV-LG

**Legend:**

- - 1/4" Hole
- - 3/8" Hole
- ▬ - Intersection



Sign, Graphics, Awning & Marine Canvas Supplies

125 Amarat Street | East Providence, RI 02915  
800-327-7562 / 401-438-4550

[www.nepcosignsupply.com](http://www.nepcosignsupply.com)

SKU#: UNIV-SM

Small Universal Bracket

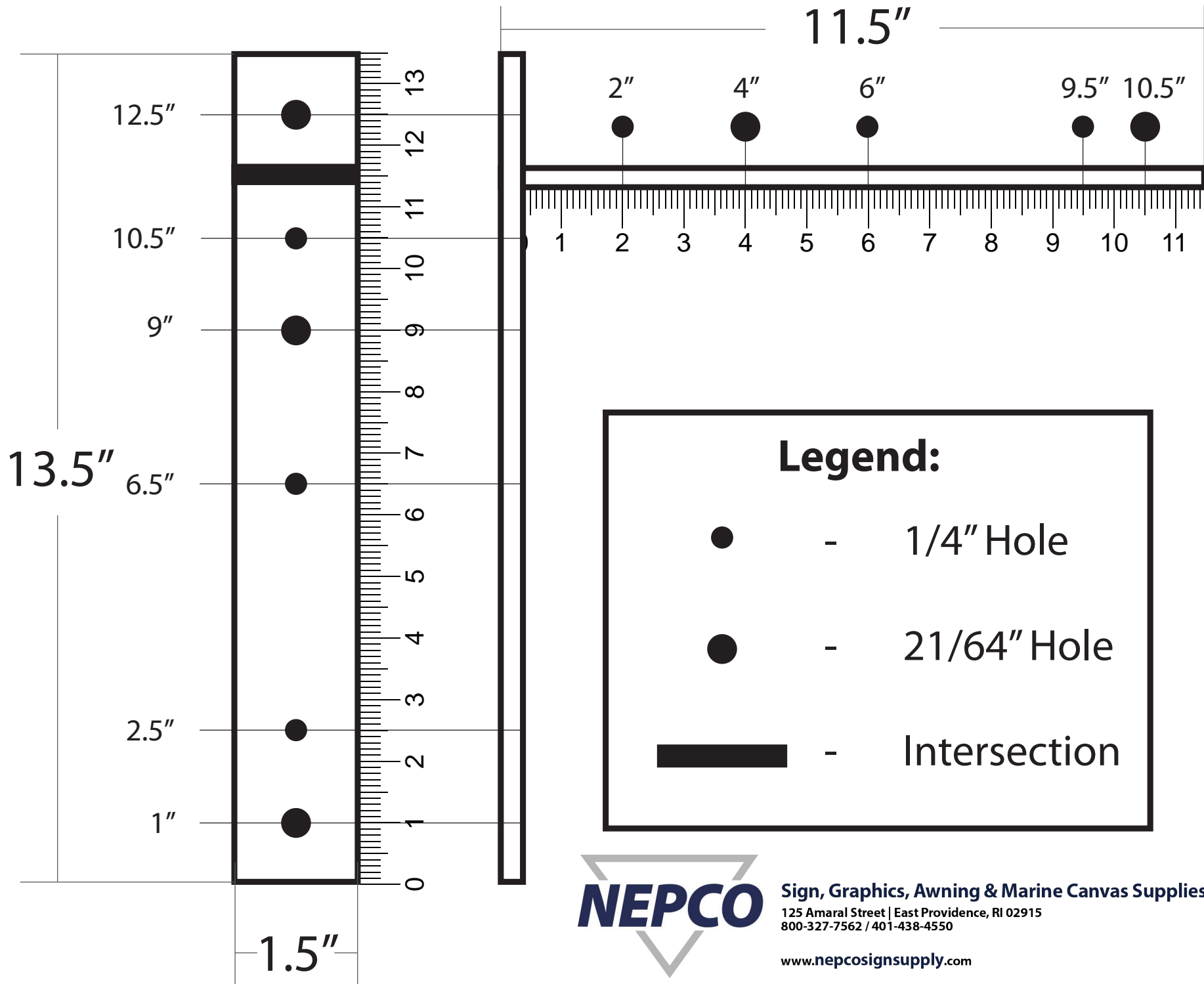

Sign, Graphics, Awning & Marine Canvas Supplies

125 Amarat Street | East Providence, RI 02915  
800-327-7562 / 401-438-4550

[www.nepcosignsupply.com](http://www.nepcosignsupply.com)

SKU#: UNIV-MD

Medium Universal Bracket

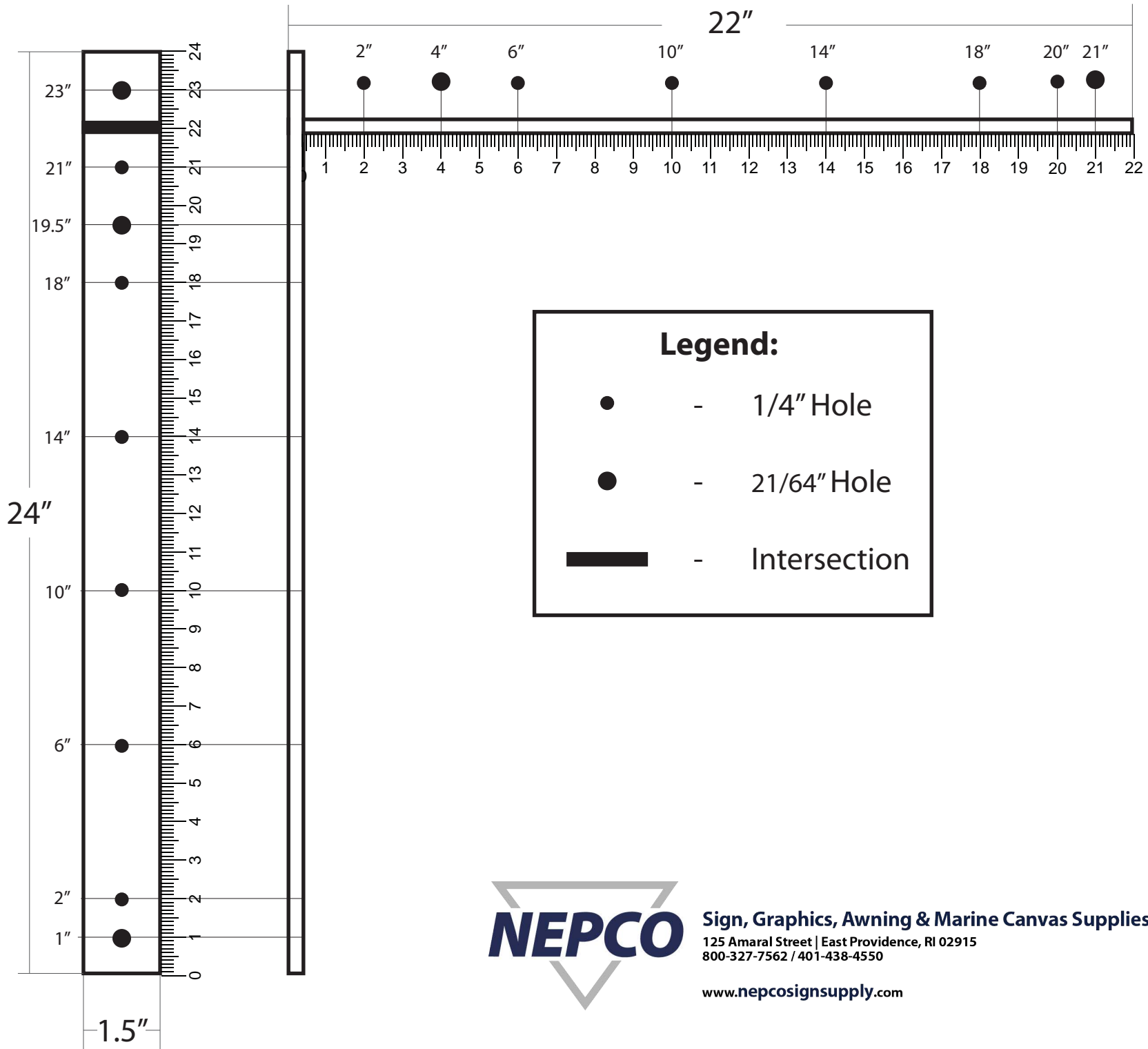

Sign, Graphics, Awning & Marine Canvas Supplies

125 Amara Street | East Providence, RI 02915  
800-327-7562 / 401-438-4550

[www.nepcosignsupply.com](http://www.nepcosignsupply.com)

SKU#: UNIV-LG

# Large Universal Bracket

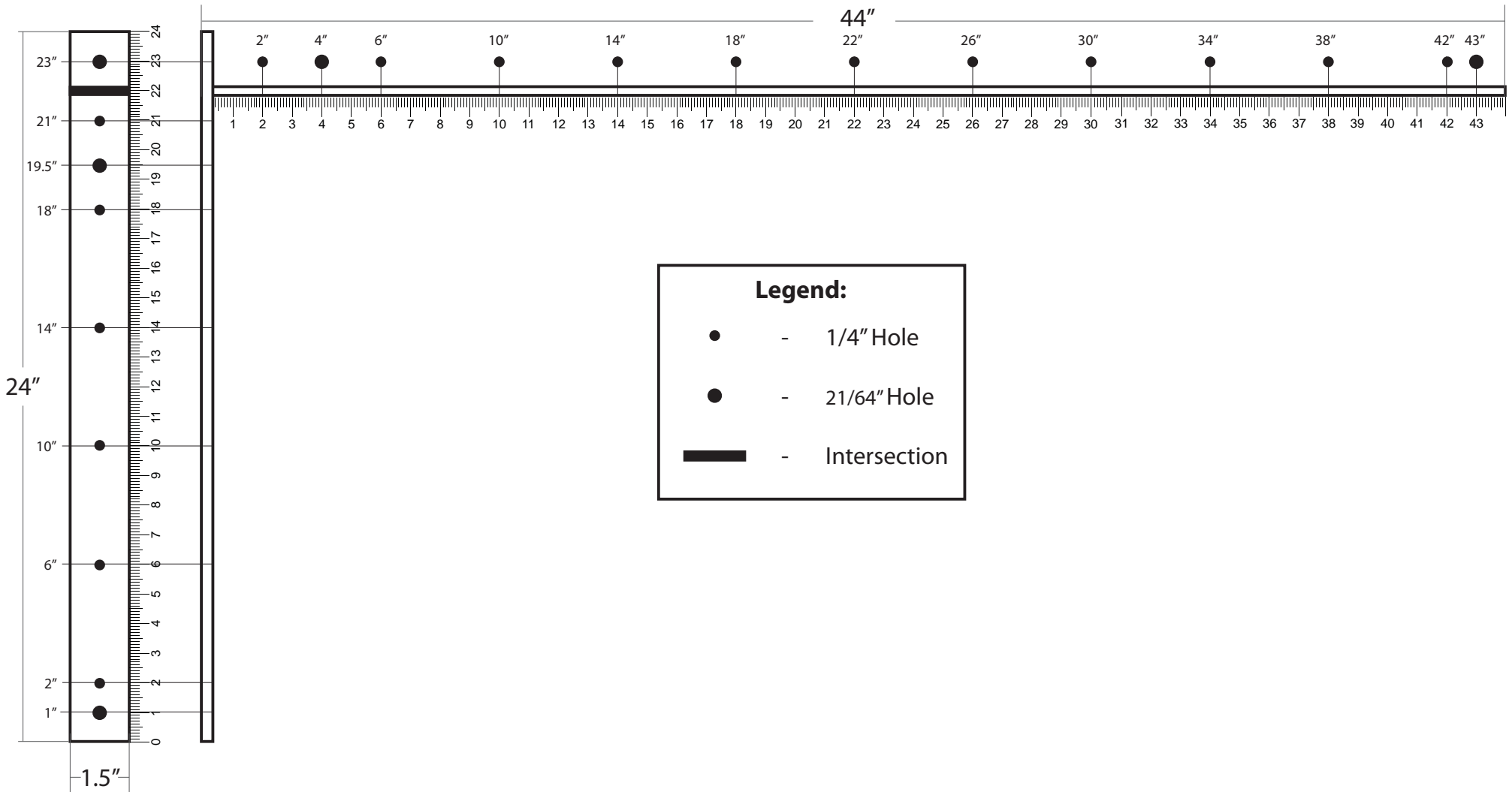

**Sign, Graphics, Awning & Marine Canvas Supplies**

125 Amara Street | East Providence, RI 02915  
800-327-7562 / 401-438-4550

[www.nepcosignsupply.com](http://www.nepcosignsupply.com)